

Project Name: _____ Location: _____

Specifier: _____ Rep Agency: _____

Fixture Type: _____ Product Code: _____

KLIK LEDpod™ XL28R35 Patented

DESCRIPTION

Discrete, easy to install, LED downlight for use in hollow metal structures such as bridges, guardrails, awnings, canopies, trellises and bus shelters. Available in both asymmetric and symmetric options with multiple lens options.

Note – Consult factory for guidance on handrail sizing; not intended for standard IBC handrail.

HOUSING

IP65, IK08, clear anodized aluminum body. Color match anodized as an option to color match the material into which the downlight can be installed.

Aluminum housing has a marine grade hard-anodized 25-micron finish, thus preventing galvanic corrosion.

MOUNTING

Unique concealed internal mounting wings hold the fixture in place, the wings are deployed via patented anti-tamper screws through unobtrusive screw holes in the bezel.

- Designed to suit 2" Pipe [Ø58mm - Ø62mm]
- Minimum internal clearance ~1-3/8", max wall thickness ~1/4"
- Cut Out: Ø~1-1/8"
- Can be customized to suit a thicker wall

ELECTRICAL/LED DRIVER

- Input Voltage: 24 VDC
- Primary Driver: KLIK provided Class II, 110 - 277 VAC UL Listed Constant Voltage
- Secondary Driver: 350 - 700mA Constant Current (provided with fixture)
- Control: 0-10V, DALI, DMX [not individually addressable]
- Enclosures: [see details below]
- Wire connectors provided; factory pre-wire available, consult factory

LISTINGS

- ETL listed, UL 1598/CSA 22.2; CE
- cETL
- IP65 [wet location]
- All IP rated luminaires tested to AS60529-2004 Degrees of protection provided by enclosures (IP Code)
- IK08 or IK10 Impact Resistant
- Class 2 Device
- International Dark Sky Certified [Color temperature must be Amber or <3000K]



Shroud for use in vertical applications

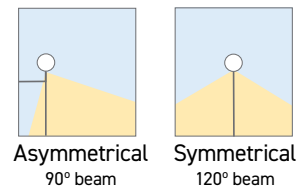
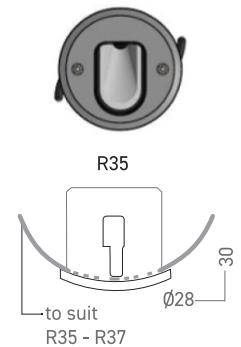

ETL listed
UL 1598/CSA 22.2; CE



Weatherproof Rating:
IP65
Wet location rated



Impact resistance:
IK08



Wildlife friendly



International Dark Sky Association Certified Amber ≤ 3000K



LED Operating Temp:
-40°F - 160°F



3G Vibration
per MIL-STD-810G



BABA Compliant
[Add Prefix 'BA-' to fixture code]

* All IP rated luminaires tested to AS60529-2004 Degrees of protection provided by enclosures (IP Code)

KLIK LEDpod™ XL28R35 Patented

SPECIFICATION TABLE

Follow the steps to specify your fixture. Enter Product Code in field at top of page. Example: XL28R3530K500AFLDCLR

| Fixture Type | Color Temp [K] | Output [W] | Distribution | Optic | Lens Options | Bezel Color Options † | Custom Wall † | Control |
|------------------------------------|------------------------------------|------------------------------|---------------------|------------------|--|---|---------------------------|----------------------|
| XL28R35 | 27K 2700K | 350 350mA 1.5W | A Asymmetric | FLD Flood | CLR Clear lens [Std] | - Marine grade anodized [Std] | 0.25 For 1/4" Wall | - 0-10V Dim |
| | 30K 3000K | 500 500mA 1.95W [Std] | S Symmetric | | FRS Opaque frost | DUL Dulux Colors - Request Guide | | DMX1 DMX 1 Ch |
| | 35K 3500K | 700 700mA 2.7W | | | OTK Optical Iter | SPC Standard Powdercoat | | DMX4 DMX 4 Ch |
| | 40K 4000K | | | | SHR Diode Shroud - Vertical Mount | BRS Antique Brass | | PH Phase Dim |
| | AMB FWC Amber | | | | | BLK Black Anodized | | |
| | PCA Phos-converted Amber | | | | | BZ Bronze | | |
| | R Red | | | | | ANT Dark Antique | | |
| | G Green | | | | | GLD Rose Gold | | |
| | B Blue | | | | | | | |
| | RGB3 RGBW 3K ^{1,2} | | | | | | | |
| RGB4 RGBW 4K ^{1,2} | | | | | | | | |

¹Additional charges and lead time apply for this feature ² RGBW limited to 4 channels at 175mA [2.5 Watt TOTAL]

| LED PERFORMANCE | | Outputs based on 3000K | | | SYMMETRICAL | ASYMMETRICAL |
|-----------------|-------------------------------------|------------------------|-----|---|------------------|--------------|
| LED: | Cree XT-E | W | mA | V | Delivered Lumens | |
| CCT: | 2700, 3000, 4000 (others available) | 1.4 | 350 | 3 | 127 | 76 |
| CRI: | 80-85 | 1.9 | 500 | 3 | 184 | 122 |
| Life: | 80% at 50k hrs and 85°C | 2.7 | 700 | 3 | 242 | 160 |
| Binning: | 3 MacAdam Steps | | | | | |
| Warranty: | 5 Year Warranty | | | | | |

REMOTE MOUNTING DISTANCE CHART

| 24 VDC 100W Driver | Approx. distance from driver to first LED at 32 fixtures | | | |
|--------------------|--|--------|--------|--------|
| Wire Size | 10 AWG | 12 AWG | 14 AWG | 16 AWG |
| Distance | 525' | 328' | 213' | 131' |

PRIMARY DRIVER

| 110 - 277 Primary Voltage Remotely Mounted Dimming Control 10" x 1.5" x 2" | Secondary LED Driver | Spacing | Maximum KLIK LEDpods™* |
|--|----------------------|---------|------------------------|
| | 700mA | 24" | 30 |
| | 500mA | 24" | 37 |
| | 350mA | 24" | 50 |

Calculations based on 2' centers between pods. Increased spacing reduces number of pods per circuit.

*Based on 16 AWG between LEDpods

REMOTE POWER SUPPLIES [PSUs]

| | |
|---------------------|--|
| LP040WPRITRDIMIP | Class 2; 40W; 0-10 Dim Constant Voltage Remote PSU [IP67 (Temp Submersion) Rated; -40°C ~ +85°C] |
| LP096WPRITRDIM | Class 2, 96W, 0-10 Dim Constant Voltage Remote PSU [IP67 (Temp Submersion) Rated; -40°C ~ +80°C] |
| LP100WPRITRDIM | Class 2, 96W, 0-10 Dim Constant Voltage Remote PSU [IP64 (Damp Location) Rated; -25°C ~ +40°C] |
| LPQZ96WUNV24VPH010 | Class 2, 96W, Phase or 0-10 Dim Constant Voltage Remote PSU [IP66 (Wet Location) Rated; -40°C ~ +60°C] |
| LPQZ96WUNV24VDMX1CH | Class 2, 96W, 8-Bit DMX Dim Constant Voltage Remote PSU [IP66 (Wet Location) Rated; -40°C ~ +60°C] |
| LPQZ96WUNV24VDMX4CH | Class 2, 96W, 8-Bit DMX Dim Constant Voltage Remote PSU [IP66 (Wet Location) Rated; -40°C ~ +60°C] |

REMOTE NEMA ENCLOSURES

| | |
|------------------|---|
| LPNEMA2RENCLJR | NEMA2 INDOOR enclosure for LP100WPRITRDIM, 12 x 3.3 x 2 |
| LPNEMA3RENCLJR | NEMA3R Drip Proof Enclosure, 4 x 4 x 12 [IP24 Equivalent] |
| LPNEMA3RXENCLSS | NEMA3 304 Lockable Stainless Steel Drip Proof Enclosure 4 x 4 x 12 [IP24 Equivalent] |
| LPNEMA4ENCLJR | NEMA4 Watertight Enclosure, 6 x 4 x 12 [IP66 Equivalent]; NEMA4X |
| LPNEMA4XENCLSSJR | NEMA4 304 Lockable Stainless Steel Watertight Enclosure 6 x 4 x 12 [IP66 Equivalent] NEMA4X |
| LPNEMA6PTRO | NEMA6 Watertight Enclosure Wiring Trough, 2 x 3 x 14 [IP68 Equivalent] |

Additional driver & enclosure configurations available, including IP68 options
 Please note the KLIK UL Listing requires purchase of a remote driver and enclosure.

KLIK LEDpod™ XL28R35 Patented FOOTCANDLE CHART

Luminaire Schedule

| Symbol | Qty | Label | Arrangement | Luminaire Lumens | LLF | Description | Filename |
|--------|-----|-------|-------------|------------------|-------|---------------------------|--|
| ● | 50 | A | Single | 154 | 0.900 | XL28R35-Dir-PCLens-AsymRe | XL28R35-Dir-PCLens-AsymRefW-LPOD-500mA-3000K-0.025m-451660-C.ies |

MH = Mounting Height [ft]

Calculation Summary

| Label | CalcType | Units | Avg | Max | Min | Avg/Min | Max/Min | Description |
|--------|-------------|-------|------|------|------|---------|---------|-------------------------|
| Bridge | Illuminance | Fc | 3.21 | 7.20 | 0.90 | 3.57 | 8.00 | readings taken at grade |

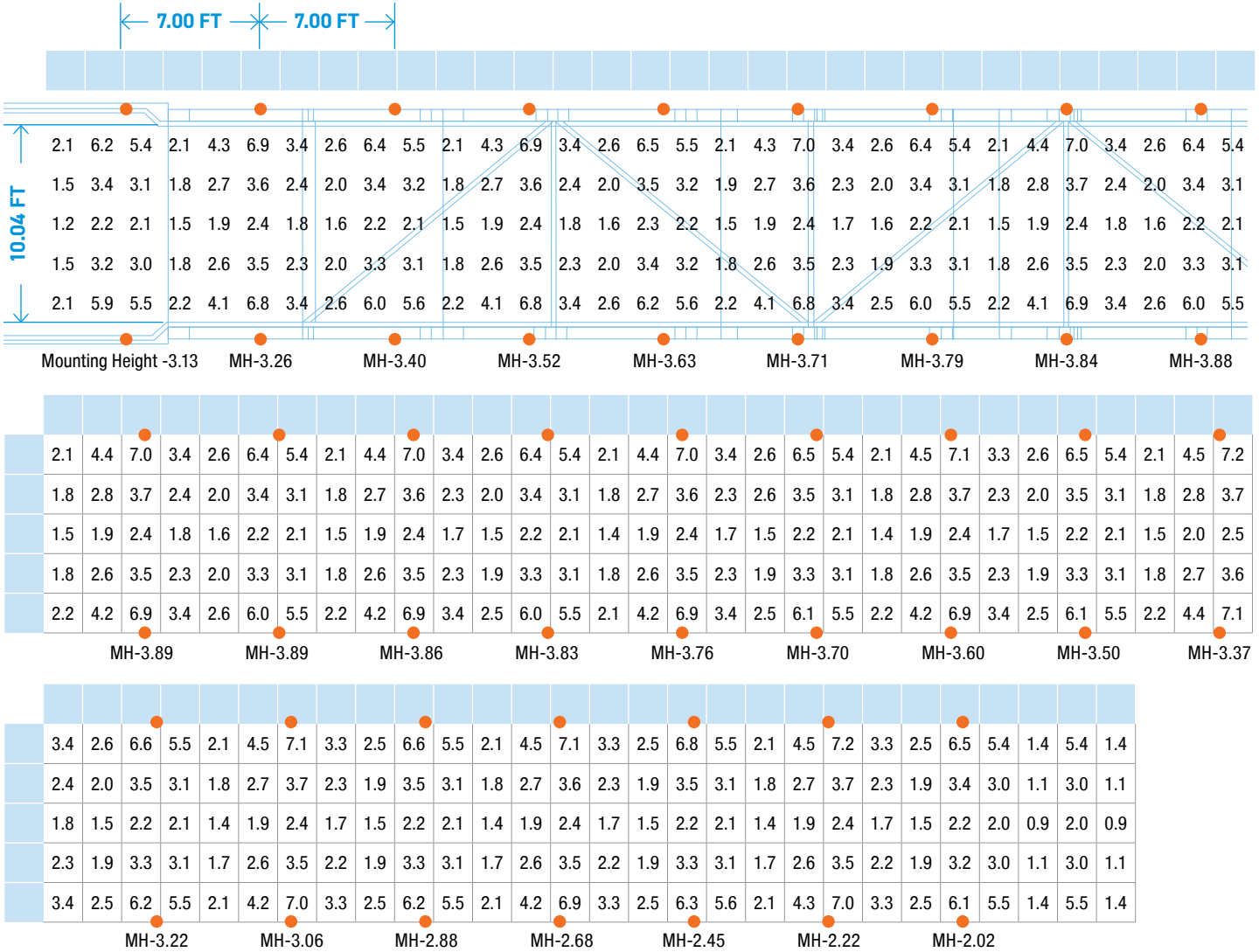

KLIK LEDpod™ XL28R35 Patented FOOTCANDLE CHART

Luminaire Schedule

| Symbol | Qty | Label | Arrangement | Luminaire Lumens | LLF | Description | Filename |
|--------|-----|-------|-------------|------------------|-------|---------------------------|--|
| ● | 50 | A | Single | 154 | 0.900 | XL28R35-Dir-PCLens-AsymRe | XL28R35-Dir-PCLens-AsymRefW-LPOD-500mA-3000K-0.025m-451660-C.ies |

MH = Mounting Height [ft]

Calculation Summary

| Label | CalcType | Units | Avg | Max | Min | Avg/Min | Max/Min | Description |
|--------|-------------|-------|------|------|------|---------|---------|-------------------------|
| Bridge | Illuminance | Fc | 3.21 | 7.20 | 0.90 | 3.57 | 8.00 | readings taken at grade |

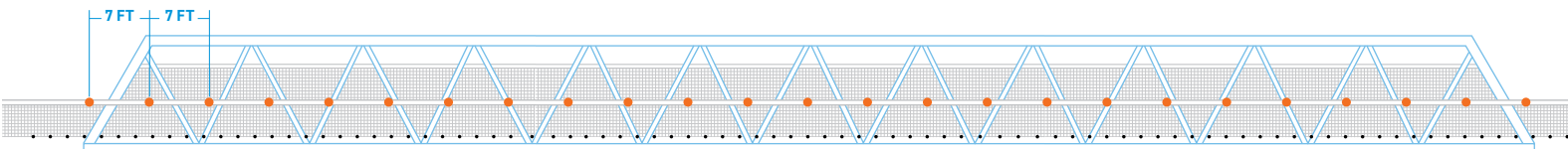
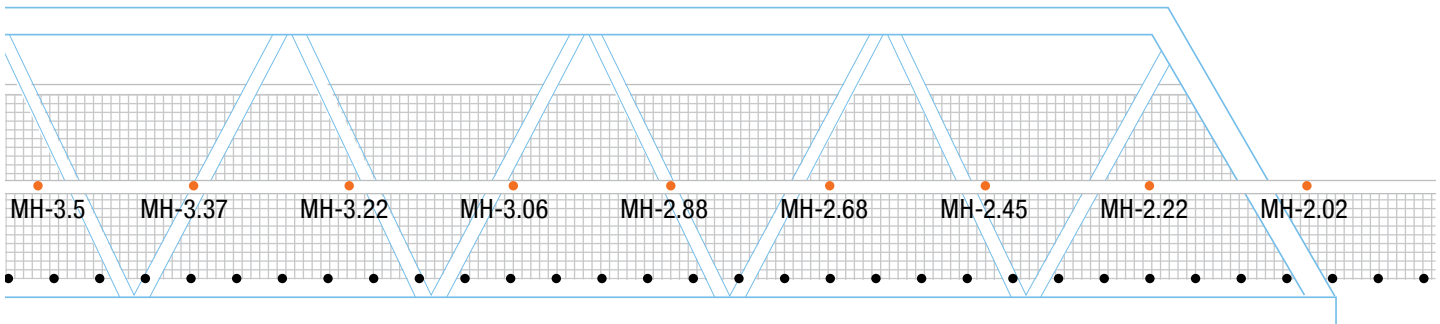
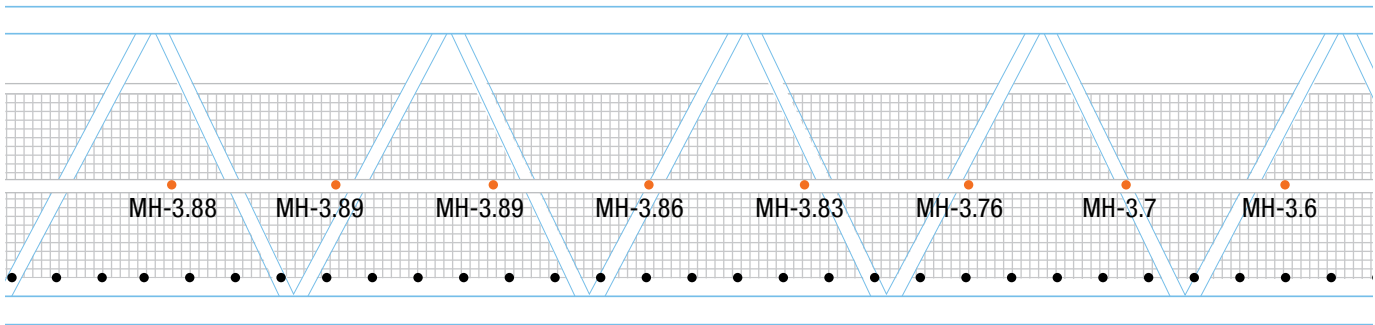
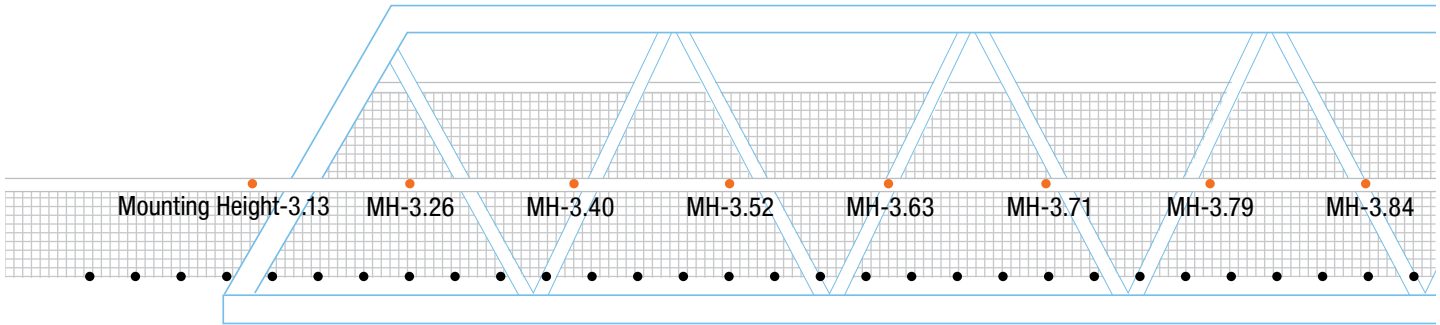

The mounting height varies, please see above [MH-X.XX]

KLIK LEDpod™ XL28R35 Patented

INSTALLATION INSTRUCTIONS Additional instructions may apply, consult factory.

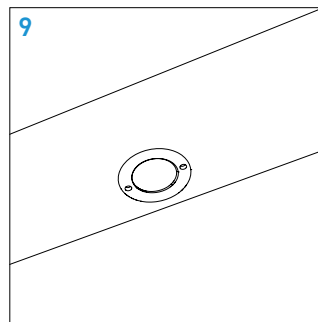
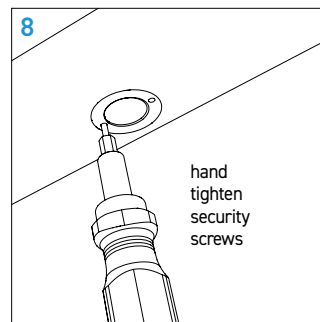
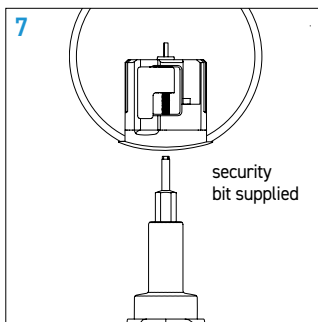
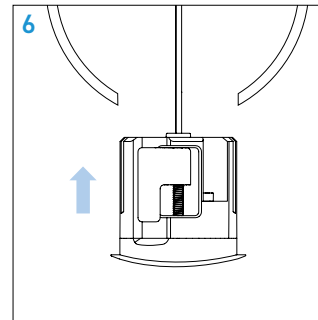
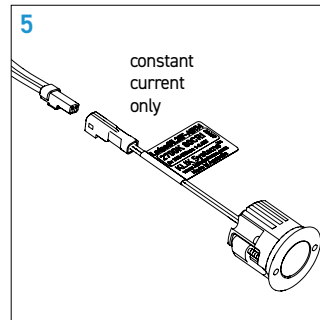
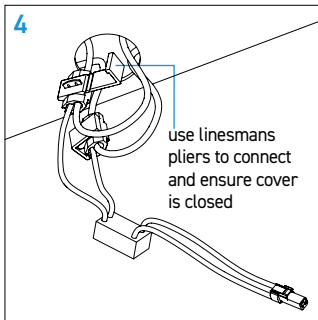
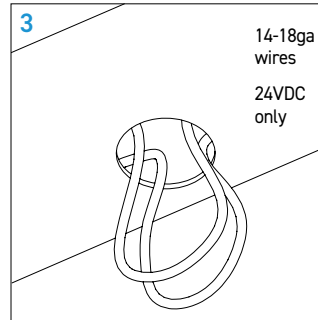
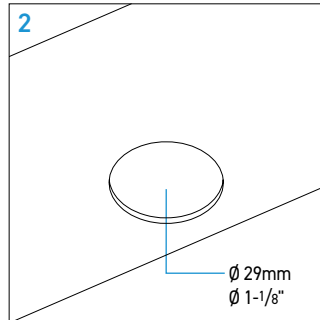
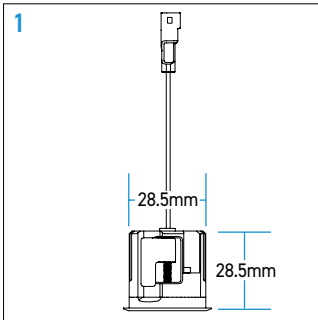

WARNING

- Risk of fire or electric shock.
- Disconnect all power before installing or servicing.
- Installation Instruction for qualified electricians only.
- Install per National Electrical Code and local regulations.
- Read Installation Instructions completely before installation.
- Failure to follow Installation Instructions may void warranties.

To reduce risk of electric shock turn off the electrical supply before installing or servicing the light fixtures and driver. Failure to do so may result in serious injury and/or damage to the components.

This product must be installed in accordance with the applicable installation code by a person familiar with the construction and operation of the product and the hazards involved.

The light source contained in this luminaire shall only be replaced by the manufacturer or the service agent or a similar qualified person.